

# America's Center Level 1

COLE STREET

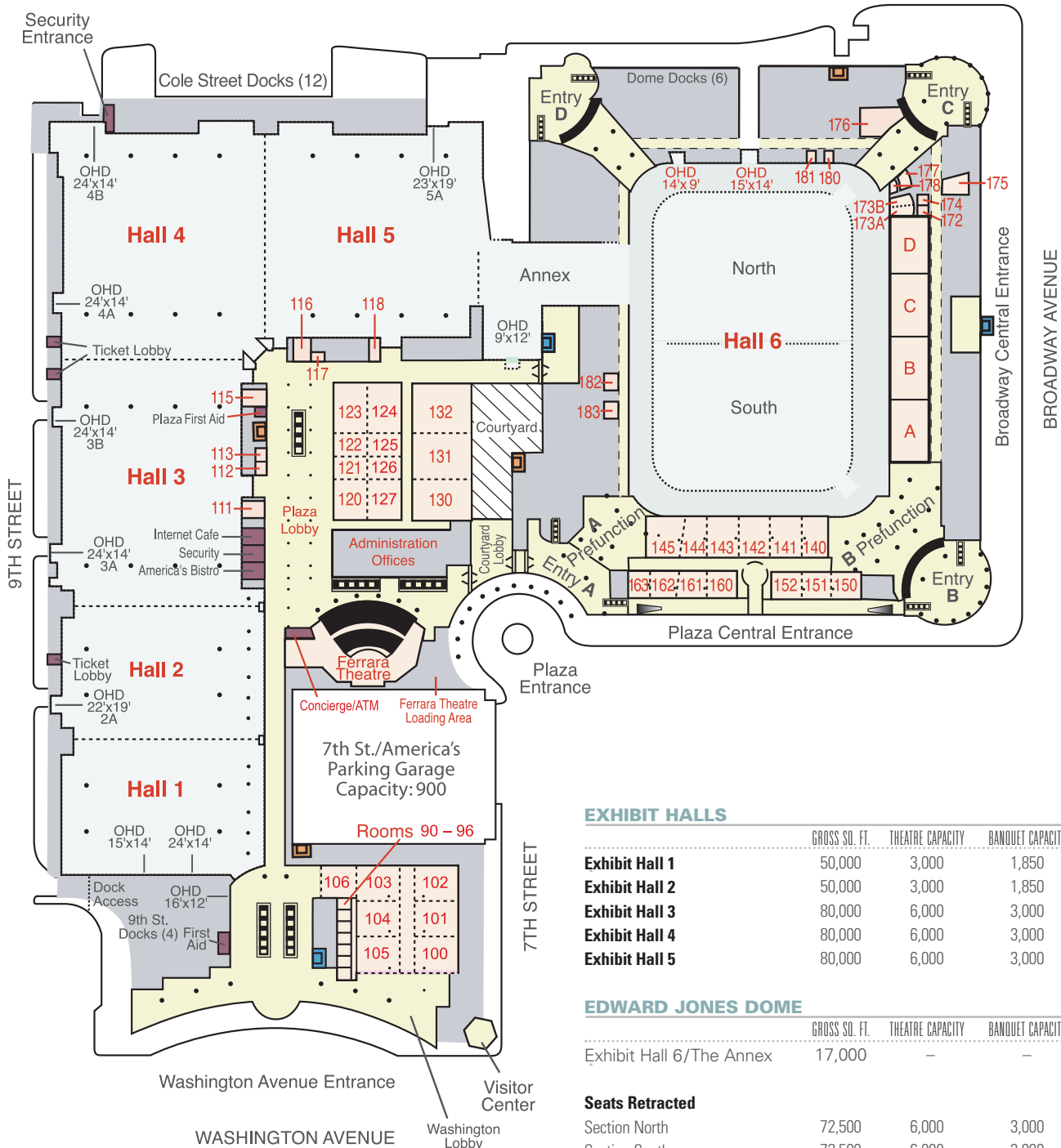

## EXHIBIT HALLS

	GROSS SQ. FT.	THEATRE CAPACITY	BANQUET CAPACITY	10x10 BOOTH CAPACITY
<b>Exhibit Hall 1</b>	50,000	3,000	1,850	225
<b>Exhibit Hall 2</b>	50,000	3,000	1,850	225
<b>Exhibit Hall 3</b>	80,000	6,000	3,000	400
<b>Exhibit Hall 4</b>	80,000	6,000	3,000	400
<b>Exhibit Hall 5</b>	80,000	6,000	3,000	400

## EDWARD JONES DOME

	GROSS SQ. FT.	THEATRE CAPACITY	BANQUET CAPACITY	10x10 BOOTH CAPACITY
Exhibit Hall 6/The Annex	17,000	-	-	40

## Seats Retracted

Section North	72,500	6,000	3,000	350
Section South	72,500	6,000	3,000	350
<b>Capacity Totals</b>	<b>145,000</b>	<b>12,000</b>	<b>6,000</b>	<b>700</b>

## Seats Extended

Section North	52,500	4,000	2,250	250
Section South	52,500	4,000	2,250	250
<b>Capacity Totals</b>	<b>104,000</b>	<b>8,000</b>	<b>4,500</b>	<b>500</b>

Hall 6 features "column free" space and is divisible to create unobstructed exhibit space as well as small and large general sessions and banquets.

Concourse Seating Capacity: 28,352 | Terrace Seating Capacity: 29,400

**LEVEL 1**

**90 Series (7 Rooms)**

ROOM #	DIMENSIONS	TOTAL SQ. FT.	CEILING HEIGHT	THEATRE CAPACITY	CLASSROOM CAPACITY	BANQUET CAPACITY
90	14' x 14'	196	8'11"	—	—	10
91	16' x 13'	208	8'11"	—	—	10
92	16' x 14'	224	8'11"	—	—	10
93	16' x 14'	224	8'11"	—	—	10
94	16' x 14'	224	8'11"	—	—	10
95	16' x 14'	224	8'11"	—	—	10
96	16' x 15'	240	8'11"	—	—	20

Notes: Show Office, Press Room, Storage Room, etc.

**100 Complex (7 Rooms)\*\***

ROOM #	DIMENSIONS	TOTAL SQ. FT.	CEILING HEIGHT	THEATRE CAPACITY	CLASSROOM CAPACITY	BANQUET CAPACITY
100	55' x 49'	2,695	13'11"	243	146	120
101	55' x 44'	2,420	13'11"	208	126	120
102	55' x 46'	2,530	13'11"	220	126	120
103	56' x 46'	2,576	13'11"	220	126	120
104	55' x 44'	2,420	13'11"	208	126	120
105	55' x 49'	2,695	13'11"	243	146	120
106	43' x 36'	1,548	13'11"	112	72	60
Corridor	21' x 141'	2,961	13'11"	—	—	—
<b>Complex Total</b>		19,845				

Notes: Movement of portable walls provide a combination of rooms in the 100 Complex.  
\*\* Six (6) 2x2 columns in complex

**Plaza Perimeter Rooms (7 Rooms)**

ROOM #	DIMENSIONS	TOTAL SQ. FT.	CEILING HEIGHT	THEATRE CAPACITY	CLASSROOM CAPACITY	BANQUET CAPACITY
111	30' x 23'	690	9'11"	—	—	30
112	13' x 14'	182	9'11"	—	—	10
113	13' x 14'	182	9'11"	—	—	10
115	30' x 22'	660	9'11"	—	—	30
116	30' x 22'	660	9'11"	—	—	30
117	17' x 9'	153	9'11"	—	—	20
118	26' x 14'	364	9'11"	—	—	30

Notes: Show Office, Press Room, Storage Room, etc.

**120 Complex (8 Rooms)**

ROOM #	DIMENSIONS	TOTAL SQ. FT.	CEILING HEIGHT	THEATRE CAPACITY	CLASSROOM CAPACITY	BANQUET CAPACITY
120	45' x 55'	2,475	13'11"	192	118	120
121	45' x 29'	1,305	13'11"	96	59	60
122	45' x 29'	1,305	13'11"	96	58	60
123	45' x 56'	2,520	13'11"	200	123	120
124	45' x 56'	2,520	13'11"	200	126	120
125	45' x 29'	1,305	13'11"	96	59	60
126	45' x 29'	1,305	13'11"	96	59	60
127	45' x 55'	2,475	13'11"	192	121	120
<b>Complex Total</b>	90' x 171'	15,390				

Notes: Movement of portable walls provides a combination of rooms in the 120 Complex.

**130 Complex (3 Rooms)**

ROOM #	DIMENSIONS	TOTAL SQ. FT.	CEILING HEIGHT	THEATRE CAPACITY	CLASSROOM CAPACITY	BANQUET CAPACITY
130	75' x 55'	4,125	13'11"	408	264	220
131	75' x 59'	4,425	13'11"	416	272	220
132	75' x 56'	4,200	13'11"	425	276	220
<b>Complex Total</b>	75' x 170'	12,750				

Notes: Movement of portable walls provides a combination of rooms in the 130 Complex.

**140 Complex (6 Rooms)\*\***

ROOM #	DIMENSIONS	TOTAL SQ. FT.	CEILING HEIGHT	THEATRE CAPACITY	CLASSROOM CAPACITY	BANQUET CAPACITY
140	55' x 36'	1,980	9'0"/13'0"	122	88	100
141	51' x 42'	2,142	9'0"/13'0"	150	104	110
142	55' x 37'	2,035	9'0"/13'0"	153	92	110
143	51' x 42'	2,142	9'0"/13'0"	150	104	110
144	55' x 31'	1,705	9'0"/13'0"	107	83	80
145	55' x 49'	2,695	9'0"/13'0"	173	93	120
<b>Complex Total</b>		12,699				

Notes: Movement of portable walls provides a combination of rooms in the 140 Complex.  
\*\* Seven (7) columns in complex.

**150 Complex (3 Rooms)\*\***

ROOM #	DIMENSIONS	TOTAL SQ. FT.	CEILING HEIGHT	THEATRE CAPACITY	CLASSROOM CAPACITY	BANQUET CAPACITY
150	38' x 39'	1,482	12'/13'6"	72	48	70
151	38' x 38'	1,444	13'6"	72	48	70
152	37' x 38'	1,406	11'6"/13'6"	75	56	80
<b>Complex Total</b>		4,332				

Notes: Show Office, Press Room, Storage Room, etc.  
\*\* Three (3) columns in complex.

**160 Complex (4 Rooms)**

ROOM #	DIMENSIONS	TOTAL SQ. FT.	CEILING HEIGHT	THEATRE CAPACITY	CLASSROOM CAPACITY	BANQUET CAPACITY
160*	37' x 38'	1,406	11'6"/13'6"	83	56	80
161*	38' x 38'	1,444	13'6"	72	48	70
162	38' x 34'	1,292	13'6"	60	48	50
163	38' x 33'	1,254	13'6"	55	41	50
<b>Complex Total</b>		5,396				

Notes: Movement of portable walls provide a combination of rooms in the 160 Complex.  
\* Rooms 160 and 161 are not available during a Dome seated event.  
\*\* Four (4) columns in complex.

**Locker Rooms**

ROOM #	DIMENSIONS	TOTAL SQ. FT.	CEILING HEIGHT	THEATRE CAPACITY	CLASSROOM CAPACITY	BANQUET CAPACITY
A	51' x 55'	2,805	10'	—	—	—
B	45' x 37'	1,665	12'	—	—	—
C	70' x 24'	1,680	12'	—	—	—
D	46' x 24'	1,104	12'	—	—	—

Notes: Rooms A, B, C and D have restrooms and showers. The locker rooms are only available if Dome is being used. Rooms A & B are utilized by the St. Louis Rams and may not be available.

**170 Series (10 Rooms)**

ROOM #	DIMENSIONS	TOTAL SQ. FT.	CEILING HEIGHT	THEATRE CAPACITY	CLASSROOM CAPACITY	BANQUET CAPACITY
172	10' x 7'	70	10'	—	—	—
173A	33' x 18'	594	12'	—	—	—
173B	33' x 15'	495	12'	—	—	—
174	11' x 8'	88	9'10"	—	—	—
175	34' x 22'	748	10'	—	—	—
176	22' x 28'	616	9'10"	—	—	—
177	15' x 14'	210	9'10"	—	—	—
178	9' x 10'	90	9'	—	—	—

Notes: Rooms 172, 174, 176, 177, and 178 have restrooms and showers.  
Room 175 has a private restroom. Rooms 173A and 173B may be combined.  
These rooms are only available if Dome is being used.

**180 Series (4 Rooms)**

ROOM #	DIMENSIONS	TOTAL SQ. FT.	CEILING HEIGHT	THEATRE CAPACITY	CLASSROOM CAPACITY	BANQUET CAPACITY
180	18' x 7'	126	7'11"	—	—	—
181	18' x 7'	126	7'11"	—	—	—
182	32' x 18'	576	12'	—	—	—
183	32' x 18'	450	10'9"	—	—	—

Notes: Rooms 182 and 183 have restrooms and showers.  
These rooms are only available if Dome is being used.

**FERRARA THEATRE**

ROOM #	DIMENSIONS	TOTAL SQ. FT.	CEILING HEIGHT	THEATRE CAPACITY
Theatre	—	—	—	1,411

Notes: Permanent seating on three levels. Permanent stage and AV equipment.

**Dressing Rooms**

ROOM #	DIMENSIONS	TOTAL SQ. FT.	CEILING HEIGHT	THEATRE CAPACITY
1	9' x 12'(actual)	108	9'	—
	7' x 10'(usable)	70	9'	—
2	12' x 10'(actual)	120	9'	—
	8' x 10'(usable)	80	9'	—

Notes: Dressing rooms have private restrooms and showers. Dressing rooms are for Ferrara Theatre use only. Permanent on three levels. Permanent stage and AV equipment.